

---

# User Guide

Nokia 106

RM-962

**NOKIA**

---

# User Guide

Nokia 106

## Contents

<b>Safety</b>	<b>3</b>
<b>Get started</b>	<b>4</b>
Keys and parts	4
Get your phone ready	4
Charge the battery	5
Lock the keys	6
<b>Basics</b>	<b>7</b>
Explore your phone	7
Change the volume	8
Change the ringtone	9
Write text	9
Use predictive text	10
<b>People &amp; messaging</b>	<b>11</b>
Make or answer a call	11
Save a name and phone number	11
Save numbers in 5 separate phonebooks	12
Send and receive messages	12
<b>Entertainment</b>	<b>14</b>
Listen to the radio	14
<b>Office</b>	<b>15</b>
Set an alarm	15
<b>Phone management</b>	<b>16</b>
Remove private content from your phone	16
<b>After-sales policy</b>	<b>17</b>
<b>Product and safety information</b>	<b>18</b>

# Safety

Read these simple guidelines. Not following them may be dangerous or illegal. For further info, read the complete user guide.



## SWITCH OFF IN RESTRICTED AREAS

Switch the device off when mobile phone use is not allowed or when it may cause interference or danger, for example, in aircraft, in hospitals or near medical equipment, fuel, chemicals, or blasting areas. Obey all instructions in restricted areas.



## ROAD SAFETY COMES FIRST

Obey all local laws. Always keep your hands free to operate the vehicle while driving. Your first consideration while driving should be road safety.



## INTERFERENCE

All wireless devices may be susceptible to interference, which could affect performance.



## QUALIFIED SERVICE

Only qualified personnel may install or repair this product.



## BATTERIES, CHARGERS, AND OTHER ACCESSORIES

Use only batteries, chargers, and other accessories approved by Nokia for use with this device. Do not connect incompatible products.



## KEEP YOUR DEVICE DRY

Your device is not water-resistant. Keep it dry.



## PROTECT YOUR HEARING

To prevent possible hearing damage, do not listen at high volume levels for long periods. Exercise caution when holding your device near your ear while the loudspeaker is in use.



## SAR

This device meets RF exposure guidelines when used either in the normal use position against the ear or when positioned at least 1.5 centimetres (5/8 inch) away from the body. The specific maximum SAR values can be found in the Certification Information (SAR) section of this user guide. For more info, go to [www.sar-tick.com](http://www.sar-tick.com).

When a carry case, belt clip or other form of device holder is used for body-worn operation, it should not contain metal and should provide at least the above-stated separation distance from the body. Note that mobile devices may be transmitting even if you are not making a voice call.

# Get started

Get to grips with the basics, and have your phone up and running in no time.

## Keys and parts

Explore the keys and parts of your new phone.

- 1 Charger connector
- 2 Flashlight
- 3 Headset connector (3.5 mm AHJ)
- 4 Scroll key
- 5 End/Power key
- 6 Microphone
- 7 Call key
- 8 Selection keys
- 9 Earpiece
- 10 Antenna area

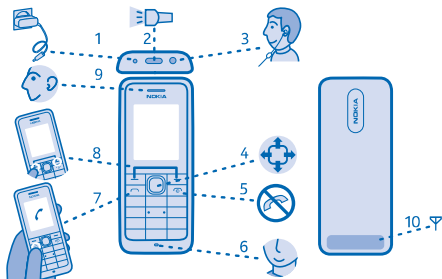

Avoid touching the antenna area while the antenna is in use. Contact with antennas affects the communication quality and may reduce battery life due to higher power level during operation.

The following headsets have been approved by Nokia for use with this device: WH-108.

Some of the accessories mentioned in this user guide may be sold separately.

## Get your phone ready

Insert the SIM card and battery.

1. Place your thumb on the logo, and carefully pull the side edge of the back cover to remove the cover.

**!** **Note:** Switch the device off and disconnect the charger and any other device before removing any covers. Avoid touching electronic components while changing any covers. Always store and use the device with any covers attached.



2. If the battery is in the phone, lift it out.

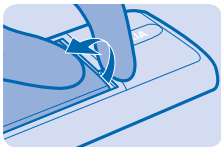

3. Slide the SIM under the holder with the contact area face down.

**!** **Important:** This device is designed to be used with a standard SIM card (see figure) only. Use of incompatible SIM cards may damage the card or the device, and may corrupt data stored on the card. Please consult your mobile operator for the use of a SIM card that has a mini-UICC cutout.



4. Line up the battery contacts, and put the battery in.

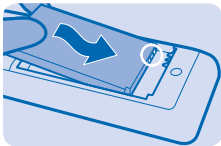

5. Press the back cover down until it locks into place.

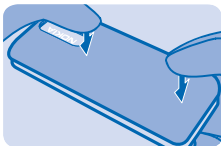

6. To switch on, press and hold .

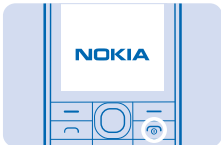

## Charge the battery

Your battery has been partially charged at the factory, but you may need to recharge it before you can use your phone.

1. Plug the charger into a wall outlet.

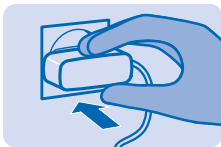

2. Connect the charger to the phone. When done, unplug the charger from the phone, then from the wall outlet.

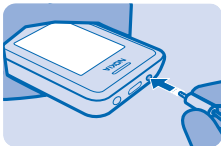

If the battery is completely discharged, it may take several minutes before the charging indicator is displayed or before any calls can be made.

## Lock the keys



Lock the keys when not using your phone.

To lock, select **Menu**, and press \*. To unlock, select **Unlock**, and press \*.



★ **Tip:** You can set your phone to ask for the lock code that you define. The default lock code is 12345.

# Basics

Learn how to get the most out of your new phone.

## Explore your phone

Explore your phone with a simple key press.

1. To see the apps and features of your phone, press **Menu**.

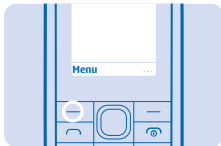

2. To go to an app or feature, press the scroll key up, down, left, or right.



3. To open the app or select the feature, press **Select**.



4. To go back to the previous view, press **Back**.



5. To go back to the home screen, press .

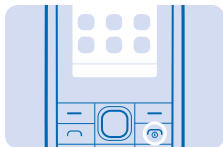

6. To use the flashlight, press the scroll key up twice. To switch off, press up once. Do not shine the light in anyone's eyes.

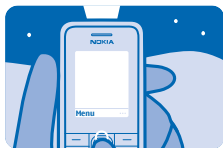

## Change the volume

You can control the audio in several ways.

1. Scroll left or right to change the volume during a call or when listening to the radio.

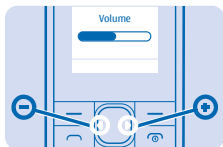

2. You can connect a compatible headset or other compatible device to the headset connector.

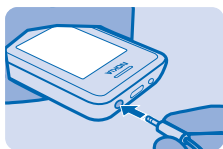

3. To use the loudspeaker on your phone when calling, select **Loudsp.**. You can also use the loudspeaker when listening to radio.





## Change the ringtone

Set a different ringtone for each profile.

1. Select **Menu > Settings > Tone settings**.



2. Select **Ringtone**.

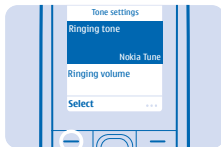

3. Pick a ringtone, and select **OK**.

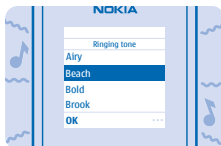

## Write text

Writing with the keypad is easy and fun.

Press a key repeatedly until the letter is shown.

**Type in a space**

Press **0**.

**Type in a special character or punctuation mark**

Press and hold **\***.

**Switch between character cases**

Press **#** repeatedly.

**Type in a number**

Press and hold a number key.

## Use predictive text

To speed up your writing, your phone can guess what you are starting to write. Predictive text is based on a built-in dictionary. This feature is not available for all languages.

1. Select **Opt.** > **Dictionary** and the language.
2. Start writing a word. When the word you want is shown, press **0**.

### Change a word

Press **\*** repeatedly until the word you want is shown.

### Add a new word to the dictionary

If the word you want isn't in the dictionary, write the word, select **Spell**, and type in the word.

### Switch between predictive and traditional text

Press **#** repeatedly.

### Switch predictive text off

Select **Opt.** > **Dictionary** > **Dictionary off**.

# People & messaging

Contact your friends and family using your phone.

## Make or answer a call

Read on and learn how to make or answer a call with your new phone.

1. Type in the phone number.

To type in the + character, used for international calls, press \* twice.

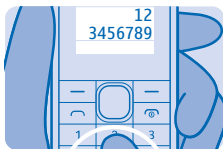

2. Press  to make the call. To end the call, press .

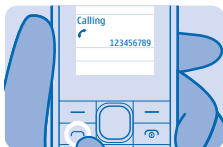

3. When someone calls you, press  to answer.

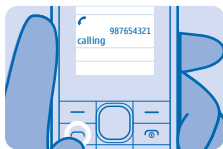

## Save a name and phone number

Add a new name and number to your phone.

1. Select **Menu > Contacts**.



2. Select **Add contact** and where you want to save the contact.

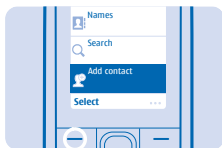

3. Write the name, and press **OK**, then type in the number, and press **OK**.

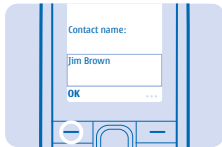

## Save numbers in 5 separate phonebooks

To use separate phonebooks, save contacts in the phone memory.

To take multi-phonebook into use, select **Menu > Contacts > Settings > Multi-Phonebook > Phonebook style > Multi-Phonebook**.

1. To add a contact to a phonebook, select **Menu > Contacts > Settings > Multi-Phonebook > Manage contacts**.

2. Select a contact, and mark a phonebook.

3. Select **Done**, and save the changes.

### Select which phonebook to use

Select **Multi-Phonebook > Current phonebook** and the phonebook you want to use.

### Rename a phonebook

Select **Multi-Phonebook > Rename phonebooks** and the phonebook, write the name, and select **OK**.

## Send and receive messages

Keep in touch with your friends and family through text messages.

1. Select **Menu > Messages**.

2. Select **Create message**.

3. Write your message.

★ **Tip:** To insert special characters, such as a smiley or symbol, select **Opt. > Insert options**.

4. Select **Opt. > Send**.

5. Type in a phone number, and select **OK**. Your message is sent.

6. To read a message you've received, select **Show** on the home screen.

7. To read the rest of the message, press down.

You can send text messages that are longer than the character limit for a single message. Longer messages are sent as two or more messages. Your service provider may charge accordingly. Characters with accents, other marks, or some language options, take more space, and limit the number of characters that can be sent in a single message.

# Entertainment

Having a spare moment and in need of entertainment? Learn how to listen to the radio on your phone.

## Listen to the radio

Use your phone to listen to the radio.

1. Connect a headset, and select **Menu > Radio**. The headset cable works as a radio antenna.

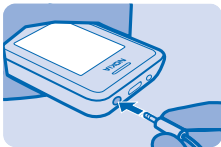

2. To go to the next channel, press down.

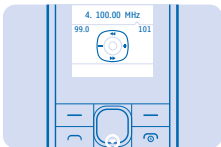

3. To close the radio, select **Options > Switch off**.

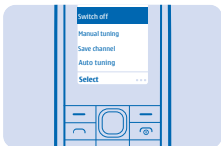

# Office

Learn how to use the calendar to keep yourself organised.

## Set an alarm

Use your phone as an alarm clock.

1. Select **Menu > Clock > Set alarms**.



2. Select an alarm.



★ **Tip:** You can set up to five different alarms.

3. To set the hour, press up or down. To set the minutes, press right and then up or down. Press **OK**.



# Phone management

Learn how you can manage personal data in your phone.

## Remove private content from your phone

If you buy a new phone, or otherwise want to dispose of or recycle your phone, here's how you can remove personal info and content.

When removing private content from your phone, pay attention to whether you are removing content from the phone memory or the SIM card.

1. To remove messages, select **Menu > Messages > Delete messages**.
2. Go to the folder you want to empty, and select **Delete all** or **All read**. To remove all messages from your phone, empty all the folders separately.
3. To remove contacts, select **Menu > Contacts > Delete > Delete all** and the location.
4. To remove call info, select **Menu > Call register > Delete recent call lists > All**.
5. Check that all your personal content has been removed.



## After-sales policy



Need assistance after you've bought your phone?



Contact the store where you bought it for help and advice.  
Keep your receipt as proof of purchase for warranty purposes.

# Product and safety information

## Network services and costs

You can only use your device on the (E)GSM 900, 1800 MHz networks. You need a subscription with a service provider.

You may also need to subscribe to some features.

## Emergency calls

1. Make sure the device is switched on.
2. Check for adequate signal strength.

You may also need to do the following:

- Put a SIM card in the device, if supported by your device.
  - Switch the call restrictions off in your device, such as call barring, fixed dialling, or closed user group.
  - If the device keys are locked, unlock them.
3. Press the end key repeatedly, until the home screen is shown.
  4. Type in the official emergency number for your present location. Emergency call numbers vary by location.
  5. Press the call key.
  6. Give the necessary info as accurately as possible. Do not end the call until given permission to do so.

**!** **Important:** Activate both cellular and internet calls, if your phone supports internet calls. The phone may attempt to make emergency calls both through cellular networks and through your internet call service provider. Connections in all conditions cannot be guaranteed. Never rely solely on any wireless phone for essential communications like medical emergencies.

## Take care of your device

Handle your device, battery, charger and accessories with care. The following suggestions help you keep your device operational.

- Keep the device dry. Precipitation, humidity, and all types of liquids or moisture can contain minerals that corrode electronic circuits. If your device gets wet, remove the battery, and let the device dry.
- Do not use or store the device in dusty or dirty areas.
- Do not store the device in high temperatures. High temperatures may damage the device or battery.
- Do not store the device in cold temperatures. When the device warms to its normal temperature, moisture can form inside the device and damage it.
- Do not open the device other than as instructed in the user guide.
- Unauthorised modifications may damage the device and violate regulations governing radio devices.
- Do not drop, knock, or shake the device. Rough handling can break it.
- Only use a soft, clean, dry cloth to clean the surface of the device.
- Do not paint the device. Paint can prevent proper operation.
- For optimal performance, switch the device off and remove the battery from time to time.
- Keep the device away from magnets or magnetic fields.
- To keep your important data safe, store it in at least two separate places, such as your device, memory card, or computer, or write down important info.

### Recycle



Always return your used electronic products, batteries, and packaging materials to dedicated collection points. This way you help prevent uncontrolled waste disposal and promote the recycling of materials. All materials of the device can be recovered as materials and energy. Check how to recycle your Nokia products at [www.nokia.com/recycle](http://www.nokia.com/recycle).

## Crossed-out wheeled-bin symbol



The crossed-out wheeled-bin symbol on your product, battery, literature, or packaging reminds you that all electrical and electronic products and batteries must be taken to separate collection at the end of their working life. Do not dispose of these products as unsorted municipal waste: take them for recycling. For info on your nearest recycling point, check with your local waste authority, or go to [www.nokia.com/support](http://www.nokia.com/support). For more info on the environmental attributes of your device, see [www.nokia.com/ecoprofile](http://www.nokia.com/ecoprofile).

## Battery and charger info

Use your device only with an original BL-5CB rechargeable battery.

Charge your device with AC-11 charger. Charger plug type may vary.

Nokia may make additional battery or charger models available for this device.

The battery can be charged and discharged hundreds of times, but it will eventually wear out. When the talk and standby times are noticeably shorter than normal, replace the battery.

## Battery and charger safety

Always switch the device off and unplug the charger before removing the battery. To unplug a charger or an accessory, hold and pull the plug, not the cord.

When your charger is not in use, unplug it. If left unused, a fully charged battery will lose its charge over time.

Always keep the battery between 15°C and 25°C (59°F and 77°F) for optimal performance. Extreme temperatures reduce the capacity and lifetime of the battery. A device with a hot or cold battery may not work temporarily.

Accidental short-circuiting can happen when a metallic object touches the metal strips on the battery. This may damage the battery or the other object.

Do not dispose of batteries in a fire as they may explode. Obey local regulations. Recycle when possible. Do not dispose as household waste.

Do not dismantle, cut, crush, bend, puncture, or otherwise damage the battery in any way. If a battery leaks, do not let liquid touch skin or eyes. If this happens, immediately flush the affected areas with water, or seek medical help. Do not modify, attempt to insert foreign objects into the battery, or immerse or expose it to water or other liquids. Batteries may explode if damaged.

Use the battery and charger for their intended purposes only. Improper use, or use of unapproved or incompatible batteries or chargers may present a risk of fire, explosion, or other hazard, and may invalidate any approval or warranty. If you believe the battery or charger is damaged, take it to a service centre before continuing to use it. Never use a damaged battery or charger. Do not charge your device during a lightning storm. Only use the charger indoors.

## Additional safety information

### Small children

Your device and its accessories are not toys. They may contain small parts. Keep them out of the reach of small children.

### Medical devices

Operation of radio transmitting equipment, including wireless phones, may interfere with inadequately shielded medical devices' function. Consult a physician or the medical device's manufacturer to determine if it is adequately shielded from external radio energy.

### Implanted medical devices

To avoid potential interference, manufacturers of implanted medical devices recommend a minimum separation of 15.3 centimetres (6 inches) between a wireless device and the medical device. Persons who have such devices should:

- Always keep the wireless device more than 15.3 centimetres (6 inches) from the medical device.
- Not carry the wireless device in a breast pocket.
- Hold the wireless device to the ear opposite the medical device.
- Switch the wireless device off if there is any reason to suspect that interference is taking place.
- Follow the manufacturer directions for the implanted medical device.

If you have any questions about using your wireless device with an implanted medical device, consult your health care provider.

## Hearing

**Warning:** When you use the headset, your ability to hear outside sounds may be affected. Do not use the headset where it can endanger your safety.

Some wireless devices may interfere with some hearing aids.

## Nickel

The surface of this device is nickel-free.

## Vehicles

Radio signals may affect improperly installed or inadequately shielded electronic systems in vehicles. For more info, check with the manufacturer of your vehicle or its equipment.

Only qualified personnel should install the device in a vehicle. Faulty installation may be dangerous and invalidate your warranty. Check regularly that all wireless device equipment in your vehicle is mounted and operating properly. Do not store or carry flammable or explosive materials in the same compartment as the device, its parts, or accessories. Do not place your device or accessories in the air bag deployment area.

## Potentially explosive environments

Switch your device off in potentially explosive environments, such as near petrol pumps. Sparks may cause an explosion or fire resulting in injury or death. Note restrictions in areas with fuel; chemical plants; or where blasting operations are in progress. Areas with a potentially explosive environment may not be clearly marked. These usually are areas where you are advised to switch your engine off, below deck on boats, chemical transfer or storage facilities, and where the air contains chemicals or particles. Check with the manufacturers of vehicles using liquefied petroleum gas (such as propane or butane) if this device can be safely used in their vicinity.

## Certification information (SAR)

**This mobile device meets international guidelines for exposure to radio waves.**

Your mobile device is a radio transmitter and receiver. It is designed not to exceed the limits for exposure to radio waves (radio frequency electromagnetic fields), recommended by international guidelines from the independent scientific organization ICNIRP. These guidelines incorporate substantial safety margins assure the protection of all persons regardless of age and health.

The exposure guidelines are based on the Specific Absorption Rate (SAR), which is an expression of the amount of radio frequency (RF) power deposited in the head or body when the device is transmitting. The ICNIRP SAR limit for mobile devices is 2.0 W/kg averaged over 10 grams of tissue.

SAR tests are carried out with the device in standard operating positions, transmitting at its highest certified power level, in all its frequency bands. The maximum recorded SAR values for this device are:

	Maximum SAR value	Frequency bands used when Maximum SAR value was recorded
When held against the head	1.27 W/kg over 10g	GSM 900
When operated at a separation distance of 1.5 centimetres (5/8 inch) from the body	0.65 W/kg over 10g	GSM 900

This device meets RF exposure guidelines when used against the head or when positioned at least 1.5 centimetres (5/8 inch) away from the body. When a carry case, belt clip or other form of device holder is used for body-worn operation, it should not contain metal and should provide at least the above stated separation distance from the body.

To send data or messages, a good connection to the network is needed. Sending may be delayed until such a connection is available. Follow the separation distance instructions until the sending is finished.

During general use, the SAR values are usually well below the values stated above. This is because, for purposes of system efficiency and to minimise interference on the network, the operating power of your mobile is automatically decreased when full power is not needed for the call. The lower the power output, the lower the SAR value.

Device models may have different versions and more than one value. Component and design changes may occur over time and some changes could affect SAR values. The latest available SAR information for this and other Nokia device models can be found at [www.nokia.com](http://www.nokia.com).

The World Health Organization (WHO) has stated that current scientific information does not indicate the need for any special precautions when using mobile devices. If you are interested in reducing your exposure, they recommend you limit your usage or use a hands-free kit to keep the device away from your head and body. For more information and explanations and discussions on RF exposure, go to the WHO website at [www.who.int/peh-emf/en](http://www.who.int/peh-emf/en).

## Copyrights and other notices

### DECLARATION OF CONFORMITY

CE 0168

Hereby, NOKIA CORPORATION declares that this RM-962 product is in compliance with the essential requirements and other relevant provisions of Directive 1999/5/EC. A copy of the Declaration of Conformity can be found at [www.nokia.com/global/declaration/declaration-of-conformity](http://www.nokia.com/global/declaration/declaration-of-conformity).

The availability of products, features, apps and services may vary by region. For more info, contact your Nokia dealer or your service provider. This device may contain commodities, technology or software subject to export laws and regulations from the US and other countries. Diversion contrary to law is prohibited.

The contents of this document are provided "as is". Except as required by applicable law, no warranties of any kind, either express or implied, including, but not limited to, the implied warranties of merchantability and fitness for a particular purpose, are made in relation to the accuracy, reliability or contents of this document. Nokia reserves the right to revise this document or withdraw it at any time without prior notice.

To the maximum extent permitted by applicable law, under no circumstances shall Nokia or any of its licensors be responsible for any loss of data or income or any special, incidental, consequential or indirect damages howsoever caused.

Reproduction, transfer or distribution of part or all of the contents in this document in any form without the prior written permission of Nokia is prohibited. Nokia operates a policy of continuous development. Nokia reserves the right to make changes and improvements to any of the products described in this document without prior notice.

Nokia does not provide a warranty for or take any responsibility for the functionality, content, or end-user support of third-party apps provided with your device. By using an app, you acknowledge that the app is provided as is. Nokia does not make any representations, provide a warranty, or take any responsibility for the functionality, content, or end-user support of third-party apps provided with your device.

The availability of particular products, services and features may vary by region. Please check with your local Nokia dealer for further details and availability of language options.

TM & © 2013 Nokia. All rights reserved. Third party products/names may be TMs of their respective owners.